

Barcode scanner quick guide

- ☞ A standard packing includes a scanner, a USB cable and a quick guide.
- ☞ Accessories include a stand, a RS232 cable, a 5V adaptor and a PS/2 cable.
- ☞ Use a piece of dry and soft cloth when cleaning the scanner.

Parts of the scanner

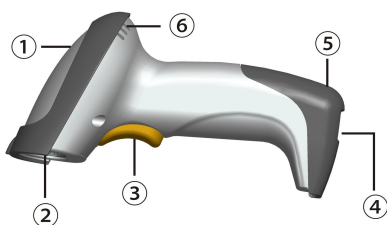

- ① LED
- ② Exit window
- ③ Trigger
- ④ Cable interface port
- ⑤ Release-hole of the cable
- ⑥ Beeper

Installing the cable

1. Switch off the host;
2. Refer to the below pictures, connect the host with the scanner based on different cables;
3. Ensure that all connections are secure.
4. Switch on the host system. If installation is successful, the beeper will beep and LED will light.

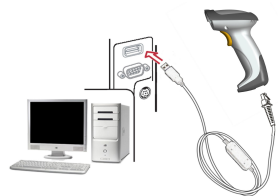

USB cable

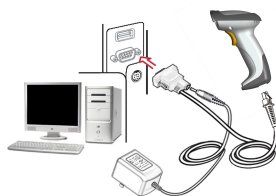

RS232 cable

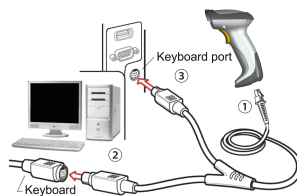

PS/2 cable

Removing the cable

1. Find the release-hole.
2. Insert a thin wire into the hole and pull out the cable gently.

Default value initialization and Firmware version list



Default value initialization



Firmware version list

Programming instruction and example

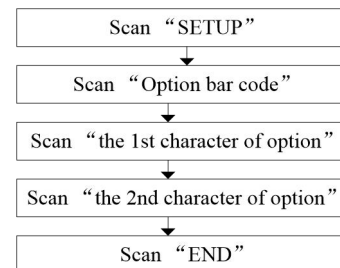

Example: to set Flow control to be XON/XOFF.

Assembling the stand (accessory)

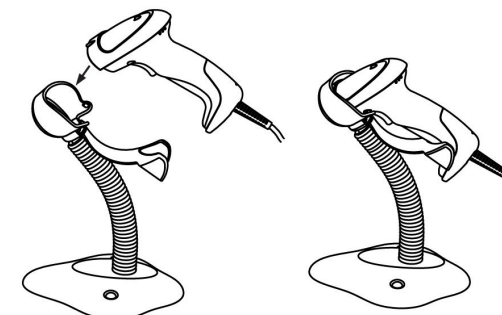
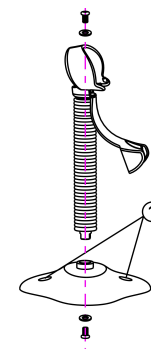

1. See the figure above, tighten the screws.
2. Bend the neck to the desired position for scanning.
3. Screw mounting: Screw one #10 wood screw into each screw-mount-hole until the base of the stand is secured.
4. Tape mounting: ①Peel the paper liner off one side of each piece of tape and place the sticky surface over each of the three rectangular tape holders. ②Peel the paper liner off the exposed sides of each piece of tape and press the stand on a flat surface until it is secure.